

GREMSpan® SYSTEM

TECHNICAL DATA SHEET

GREMSpan® system consists of tight cellular rubber foam and a **Gremtube®** heat-shrinkable standard polyolefin sleeve.

Gremspan® system consists of:

- *Acoustic protection*
- *Spacing between two parts*
- *Anti-vibratory chock*
- *Anti-icing protection*

ADAPTABILITY

Gremspan® system is made according to your needs, including the choice of foam whose thickness can vary.



GREMSPAN® SYSTEM

IMPLEMENTATION

Gremspan® system does not require any specific tools and is simple to implement. It can be easily retracted using standard processes such as a hot air gun, shrink tunnel, drying oven, etc.

The **Gremspan® system** is designed to be implemented in concurrent time and ensures components adhere permanently to each other.

This tailor-made product is created to order according to your specifications. We will determine the system best suited to your needs, depending on the application and environment in which it will be used.

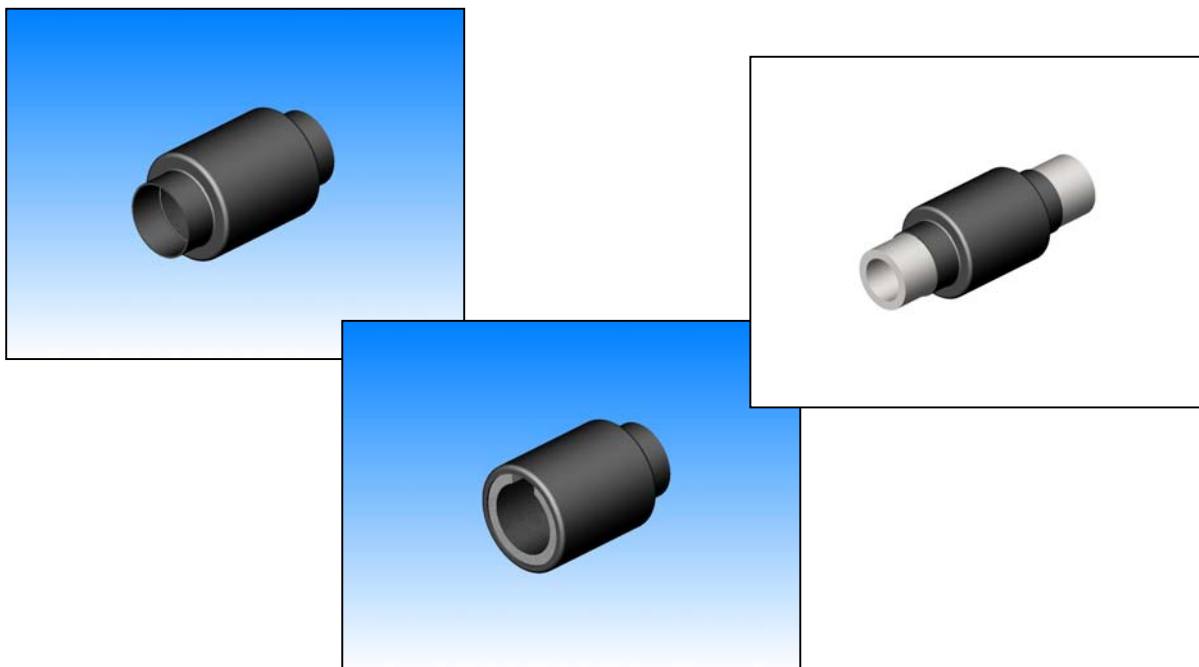

We certify that the values provided are as accurate as possible. Use of these values, however, remains the sole responsibility of the customer and cannot in any way substitute for testing the product under real conditions of use. The user must assess whether this product is suitable for a particular use. Gremco shall not be held responsible for any loss or anomaly resulting from the correct or incorrect use of this product.